

SPECIFICATION OF RID SERIES

APPLICATIONS

The RID balun cores are used for wideband transformers and balance to unbalance transformers. But today they can be found wide application not only in the input circuits to TV and FM tuners but also in CATV , MATV networks and installations.

ORDERING CODE

N7B RID 7.5 x 4 x 13 - 4.1

(1) (2) (3) (4) (5) (6)

(1) MATERIAL

(2) PRODUCT CODE

(3) A DIM.

(4) B DIM.

(5) D DIM.

(6) C DIM.



SHAPE

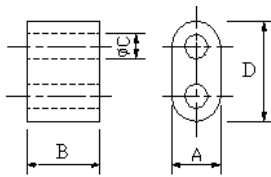

FIG 1

DIMENSIONS

UNIT:mm

NO.	ORDERING CODE	A	B	C	D	Fig
1	RID 2.2x5.5x7.5-0.7	2.20±0.20	5.50±0.30	0.70±0.15	7.50±0.30	1
2	RID 2.5x6x5-1.2	2.50±0.20	6.00±0.30	1.20±0.15	5.00±0.20	1
3	RID 3x2x5-1.25	3.00±0.20	2.00±0.20	1.25±0.15	5.00±0.30	1
4	RID 3x3x5-1.25	3.00±0.20	3.00±0.20	1.25±0.15	5.00±0.30	1
5	RID 3x3x5-1.4	3.00±0.20	3.00±0.20	1.40±0.15	5.00±0.30	1
6	RID 3x5x5-1.5	3.00±0.20	5.00±0.30	1.50±0.15	5.00±0.30	1
7	RID 3.5x7.4x8-1.8	3.50±0.20	7.40±0.30	1.80±0.15	8.00±0.30	1
8	RID 4.1x3.2x7-1.8	4.10±0.20	3.20±0.20	1.80±0.15	7.00±0.30	1
9	RID 4.1x4x7-1.8	4.10±0.20	4.00±0.20	1.80±0.15	7.00±0.30	1
10	RID 4.1x6.3x7-1.8	4.10±0.30	6.30±0.30	1.80±0.15	7.00±0.30	1
11	RID 6.5x4x12-3.8	6.50±0.40	4.00±0.20	3.80±0.20	12.00±0.30	1
12	RID 7.5x4x13-4.1	7.50±0.30	4.00±0.30	4.10±0.20	13.00±0.40	1
13	RID 7.5x7x13-4.1	7.50±0.40	7.00±0.30	4.10±0.20	13.00(+0.50/-0.30)	1
14	RID 7.5x10x13-4.1	7.50±0.30	10.00±0.30	4.10±0.25	13.00±0.50	1